

823 AS 15 15

□ □
DX
SX

New



FOR YOUR SAFETY WARNING



kg ?
www.camar.it/warning





3D  5 mm  10 mm  3  

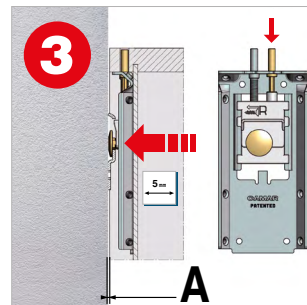
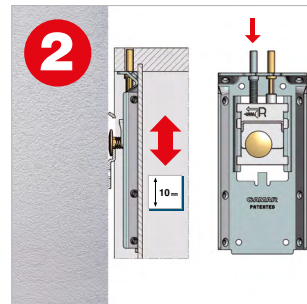
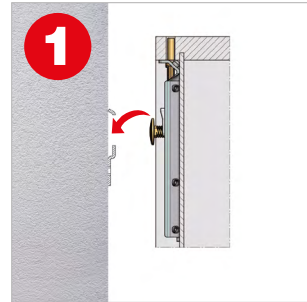



Fe  ZAMAK 

 50  1800  100



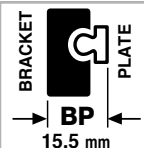

A = 3-5 mm
 
A = 0-3 mm
 

-   After assembly, verify that the anti-drop system has been activated.
-   Verificare dopo il montaggio l'avvenuta attivazione del sistema antigancio.

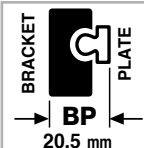
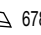
  **877 A5 PZ 00 60**  679
877 A5 Z1  679
877  680

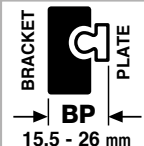
  **877 A5 PZ LA 60**  678

  **877 A5 Z1 DP 60**  677

 **810 15**  652